

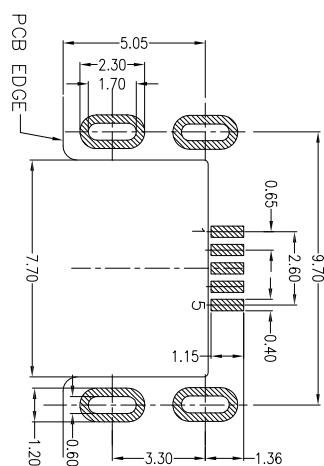

RoHS
Compliant
2002/95/EC
Process
Capable

Halogen Free

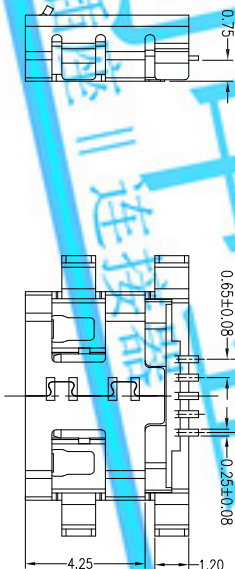
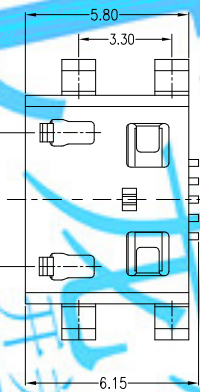
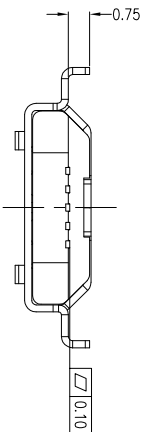

RECOMMENDED PCB LAYOUT

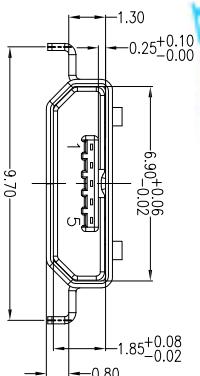

- NOTES:
1. ELECTRICAL:
 - 1) VOLTAGE CURRENT RATING: PIN1&5 1.8AMP MAX / PIN2&3&4 1AMP MAX, 30V AC;
 - 2) INSULATION RESISTANCE: 100MΩ MIN;
 - 3) CONTACT RESISTANCE: 30mΩ MAX;
 - 4) WITHSTANDING VOLTAGE: 100V AC; FOR 1 MIN.
 - 5) OPERATING TEMPERATURE: -30°C TO +80°C.
 2. Mechanical:
 - 1) Mating Force: 35N MAX
 - 2) Unmating Force: 10N MIN.
 3. DIMENSIONS MARKED "▲" TO BE CHECKED BY Q.C & IPQC.

4. PART NO.

MUYF-05*1-4BHUA378
 1AU 1U"
 6AU 30U"
 T-TIN
 NICKEL
 W:WHITE
 B:BLACK
 1-PA6T
 2-PA6T
 3-PA9T
 4-LCP

Bill of materials:

3	SHELL	COPPER ALLOY	1	PLATED TIN
2	HOUSING	LCP+30%GF	1	UL94V-0
1	TERMINAL	COPPER ALLOY	5	PLATED GOLD
ND	PARTS	MATERIAL	QTY	FINISHING

X: ±0.35	X': ±2°	UNITS	mm
.X ±0.30	.X' ±1°	MAT'L	SEE NOTE
.XX ±0.25	.XX'	FINISH	SEE NOTE
.XXX ±0.15	.XXX'	Q'TY	SEE NOTE

TITLE:		LONGCHUANG ZHONGYE (HK)CO.,LIMITED	
DR:		2018/9/5	
CHKD:		2018/9/5	
APPD:		2018/9/5	
PART NO.:		MUYF-05XT-4BHUA378	
SCALE:		5:1	
SHEET:		1/1	
REV:		A	
CUSTOMER DRAWING:			

REV.	ECN. NO.	APPD.